

Raumatic

DIGITAL 3D COOLING SYSTEM

BF-630PG



CONTENTS

- 1. Installation Instructions 1
 - Suitable Installation Place..... 1
 - Grounding 1
 - Correct usage of Refrigerator 1
 - Installation Process..... 1
- 2. Safety Instructions 2
- 3. Looks Out of Order, But, Not..... 6
- 4. Name of Each Part & Function..... 8
 - Temperature regulation
- 5. Control Buttons & Indicators 8
- 6. Care & Cleaning..... 10
- 7. Helpful Hints 11
- 8. Efficient Storage of Foods 11

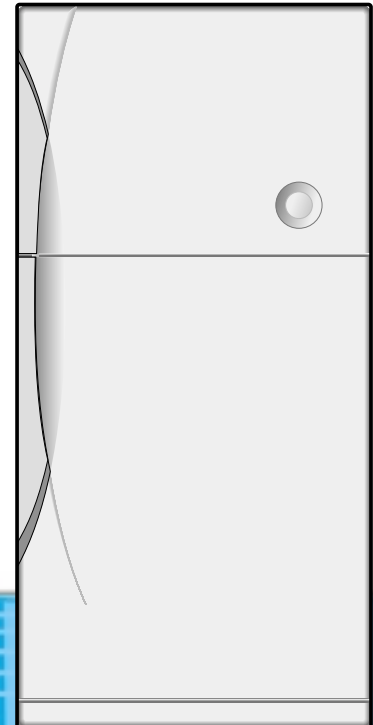

1. Installation Instructions

Suitable Installation Place

Where the floor is solid and level	Where ventilation is good	Where there is little or no heat, moisture
<ul style="list-style-type: none"> • Unstable installation causes vibration and noise of refrigerator. • Wooden floor or carpet can be discolored under the refrigerator. • Doors look hanged down due to the twist of refrigerator unless it is leveled. 	<ul style="list-style-type: none"> • More than 10 cm from 3 sides (left, right and back) is good enough for ventilation. • Insufficient space causes the noise of vibration, weakening of refrigerating power and the waste of electricity. 	<ul style="list-style-type: none"> • Direct sun rays, side heat of stove and gas range can weaken the refrigerating power. • Avoid location by a sink or where moisture and water can cause rust and corrosion. • Avoid location where moisture can cause electrical problems. • Use hard board or plank on the concrete/cement floor.

Grounding

■ Grounding terminal is the green one connected to the power cord in the back of refrigerator.

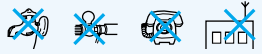
Grounding is necessary where	water can splash easily ; bathroom etc.	there is much moisture ; basement etc.	any wet and/or watery places.
Grounding by using grounding wire	Bury copper plate to which grounding wire is connected 25 cm deep in the ground.		
Grounding by using short-circuit breaker	Short-circuit breaker is a must where the floor is always wet, for example, fish shop, restaurant kitchen etc.		
Grounding is not necessary	in case of using side-grounded outlet.		
You should not connect the ground wire to	water pipe, gas pipe, telephone line, lightening-rod. There can be explosion or fire.		

Correct usage of Refrigerator

Plug in the refrigerator right after installation.	* See page 2 for details.
Set the both compartments' temperature to "3" to perform preparatory run for 2 or 3 hours. When the inside is cold enough, put the foods in.	* When the surrounding temperature is hot in midsummer, do not open and shut the doors too often after installation.



Installation Process

Attach the height adjustable legs to their holes in the left and right bottom of refrigerator.
Adjust the height by turning the legs until they touch the floor.

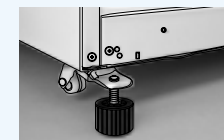
- Let the right adjustable leg touch the floor firmly, while the left, smoothly.



2. Safety Instructions

 WARNING	■ Improper use can cause physical damage - personal injury.
 ATTENTION	■ Improper use can cause injury or material damage to the household



CAUTION:

1. If the supply cord becomes damaged, it must be replaced by the manufacturer or its service agent or a similarly qualified person in order to avoid a hazard.
2. The appliance is not intended for use by young children or infirm persons without supervision.
3. Young children should be supervised to ensure that they do not play with the appliance.

WARNING

VENTILATION

In case of gas leak, ventilate the room instead of unplugging the refrigerator.

- Explosion or fire may happen.

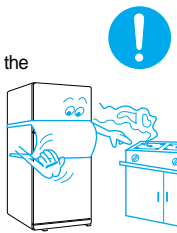

EXCLUSIVE POWER OUTLET

Use exclusive power outlet for the refrigerator only.

- Several plugs in an outlet may cause fire.
- Do not use a double outlet or extension cord.

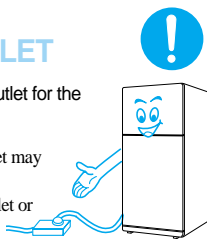

ATTENTION

Do not eat any frozen food immediately from the freezer compartment.

- It can get you cold-burns.



DISCARDING

When discarding the refrigerator, remove the door packing.

- Children may be trapped inside it.

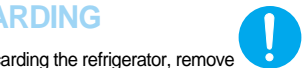

CLEAN PLUG

Unplug and clean it with dry cloth if dirty.

- Dusty and dirty plug may cause fire.



NO

Never install the refrigerator where there is much moisture and water can splash.

- It can be a danger of short circuit or fire.



NO

Do not put heavy things or water contained tanks on top of refrigerator.

- It's dangerous when they fall down and fire by short circuit can happen.

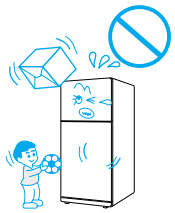

WARNING

NO

Never install the refrigerator where there is much moisture and water can splash.

- It can be a danger of short circuit or fire.

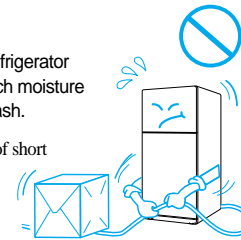

NO

Do not allow children to hang on the doors.

- The refrigerator may be tipped over to hurt children.

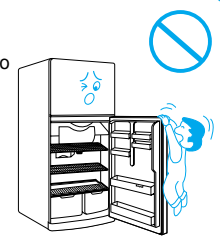

NEVER USE

When you smell something strange burning out of refrigerator, unplug it to stop running.

- It's very dangerous to keep the abnormal refrigerator running on and on.

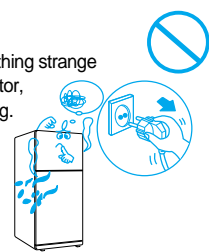

NEVER USE

Never use plug if it is loose.

- There can be electric shock or fire by short circuit.

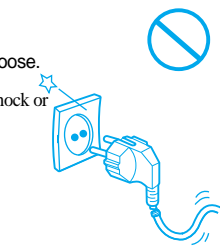

NEVER USE

Never use any spray near the refrigerator.

- It can cause danger of explosion.

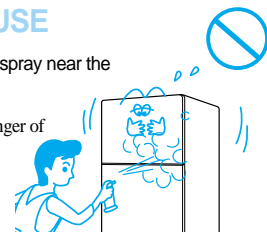

NEVER EAT

Never eat deteriorated food stored too long in the refrigerator or in the out-of-order refrigerator.

- You can be food-poisoned.



NEVER STORE

This refrigerator is for storing only foods.

- Do not store medicines, flammable things, and study sample, etc.



NEVER DISASSEMBLE

Do not repair the refrigerator on your own.

- It can work abnormally and cause bigger trouble.



NEVER TOUCH

Do not use any sharp tools when cleaning the inside.

- The cooling system can be damaged or there may be electric shock.



NEVER TOUCH

Do not pull and/or push the plug with wet hand.

- There can be danger of electric shock.

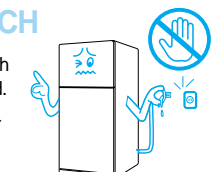

! WARNING

UNPLUG

Unplug first when exchanging the bulb and/or cleaning the refrigerator.

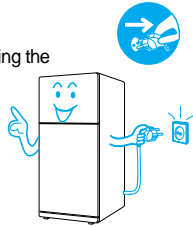

UNPLUG

If not using refrigerator for a long time, unplug and take all the foods out.

- In case of power failure, foods may decay and other accident (short circuit, fire etc.) can happen.

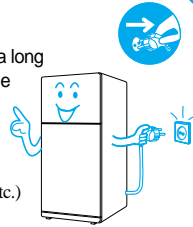

UNPLUG

Grip the whole plug body to pull when you unplug.

- Holding only the wire can cause electric spark or short circuit.

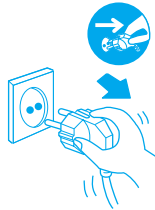

GROUNDING

Be sure to ground.

- There is a danger of electric shock due to short circuit or mal-function.

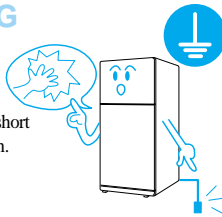

! WARNING

MOVING/ CARRYING

When you move the refrigerator, take all the foods out and empty the ice box and evaporation dish of water.

- Foods may be damaged and you can slip on watery floor.



MOVING / CARRYING

Lift the refrigerator up enough not to scratch a soft floor.

- Front and rear wheels under the refrigerator may scratch the floor.



MOVING/ CARRYING

Grip two handle bars front bottom and formed handle top back of refrigerator.

- Gripping other parts can be slippery and dangerous.

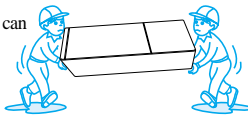

INSTALLATION

Place on a solid and level floor.

- Unstable installation causes distortion of cabinet and doors.

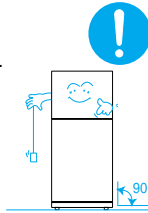

HEIGHT ADJUSTING FEET

When turning up the feet, lift the set a little.

- It is hard to turn them up unless the set is lifted.



HEIGHT ADJUSTING FEET

When moving and carrying the set, turn the feet up.

- If the feet touch the floor, they can be broken or the floor may be scratched.



! WARNING

DOOR HANDLES

Opening and shutting doors, hold door handles, not other part.

- Your fingers may be jammed to be hurt.

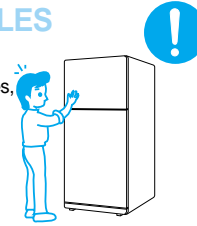

FOOD STORAGE

When you store foods in the pockets, push in to the pocket bottom.

- Tall bottles may fall down or the pockets can be broken.



POWER FAILURE

In case of power failure, open and shut the doors as seldom as possible.

- Cold air comes out and fresh storage, impossible.

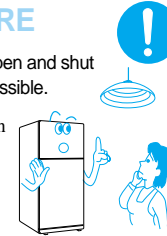

HAND OVER

Handing over this refrigerator, you'd better give user's guide together to him/her.

- New user may not know well how to use this refrigerator.

DRIVE / RUN

After you unplugged refrigerator, wait 5 minutes or more to plug in again.

- If you plug in again immediately, electric parts can be damaged.

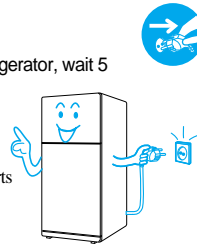

CAUTION

If there is water or oil on the floor around refrigerator, wipe it out.

- There is danger of slipping over to be hurt.



ATTENTION

Foods should not protrude from shelves.

- They can fall down and/or be broken when opening the door.



FORBIDDEN

Do not store bottles, cans or canned food in the freezer compartment.

- They can be broken or exploded by expansion of freezing.

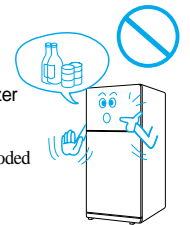

DO NOT TOUCH

Do not touch cold surfaces of foods or food containers in the freezer compartment directly.

- They are in the state of like frozen metal, so skin can adhere to these cold surfaces. (Especially when your hands are wet and damp.)



DO NOT TOUCH

Do not reach out your hands or legs under the refrigerator (when cleaning under the refrigerator).

- You can be hurt by rough edges and parts under the refrigerator.

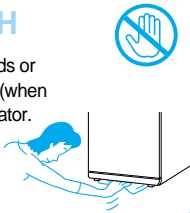

3. Looks Out If Order, But, Not.

■ Before calling for service, check the followings.

Foods freeze in the fresh food compartment

- Has the temperature been on “3” continuously?
- Is the temperature near refrigerator less than 5°C?
- Was moist foods such as vegetables placed just in front of the cold air duct?

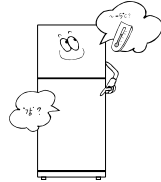

Refrigerator never get cold.

- Is there no power failure?
- Is the mains plug firmly secure.

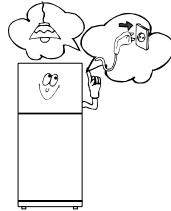

Refrigerator does not get cold enough.

- Has the temperature been on “1” continuously? Set the temperature to “2”.
- Has too hot food put in? Check food storage state.
- Is the inside filled with too much food?
- Is either door open or did you open and shut the doors too often?
- Is there a gas range or a stove near the refrigerator? Is it in direct sun-light? Check the installation place.



Refrigerator is noisy.

- Is the floor firm and level or the refrigerator levelled well ?
- Is the back of refrigerator touching the wall ?

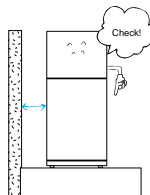

Refrigerator Is Not Wrong or Out of Order In These Cases...

Moisture is forming on cabinet surface !	<ul style="list-style-type: none"> • Moisture can be formed during the rainy season or through continuous hot and humid days. Wipe out the surface with dry cloth.
It sounds water-flowing in the refrigerator.	<ul style="list-style-type: none"> • The sound can be heard when the compressor stops. When refrigerant to cools down, the system can make such a sound.
Doors are not opened easily.	<ul style="list-style-type: none"> • Such case happens when you open the door right after closing it. Do not try to force the doors to open; wait about 30 seconds or so.
Front feels warm.	<ul style="list-style-type: none"> • Front part of cabinet may feel warm because of the hot-pipe to prevent the forming of moisture.
Cracking sound comes out of the inside.	<ul style="list-style-type: none"> • When the parts inside shrink and expand due to temperature change, such sound can be heard.
Freezer compartment door is opened and shut slightly.	<ul style="list-style-type: none"> • When you shut the fresh food compartment door quickly, the freezer compartment door is opened and shut slightly of itself. That's because of the condensed air in the fresh food compartment run to the freezer compartment by closing the door.
Frost forms inside the fresh food compartment	<ul style="list-style-type: none"> • When the surroundings are hot and humid, if you open and shut the doors frequently. When you store watery food unwrapped, frost may also form. It is all because of the moisture in the air being trapped inside.
Noise comes by opening the door or controlling quick pocket.	<ul style="list-style-type: none"> • When Air-Curtain is on to block the warm air or Quick-Pocket is working to make concentrated cooling to the pockets, electric motor is working and makes such noise. This is not a fault.

Moisture collects inside.	Water is flowing out when moving the refrigerator.	Something smells.
<ul style="list-style-type: none"> ■ Check if either door is open. ■ Did you leave the doors open too long or is moist food put with its lid off ? <p>Moisture disappears naturally if doors are closed, but it's better to wipe it off with dry cloth.</p>	<ul style="list-style-type: none"> ■ Have you dried and emptied the evaporator dish? 	<ul style="list-style-type: none"> ■ Air ducts blocked with foods ? ■ Is strong odoring food stored unwrapped ? Check the food storage state. <p>* The vegetable cases are closed, so deodorizing is almost impossible.</p>



4. NAME OF EACH PART & USAGE

FRESH CASE

- Stores food at 0~1°C to keep it of its own natural taste and nutrient.
- * Push the case backward completely, or it may touch the door to be broken.

ANTI-MICROBE DEODORIZER

- Anti-Microbe deodorizers, permanent and no need to replace or repair, get rid of odor.

FRESH FOOD COMPARTMENT SHELF

- Provided to store day to day food.

VEGETABLE DRAWER WITH FRUIT DRAWER

- Rails are installed for easy drawing

FRONT COVER

- Don't let the children step on it for it can be broken.

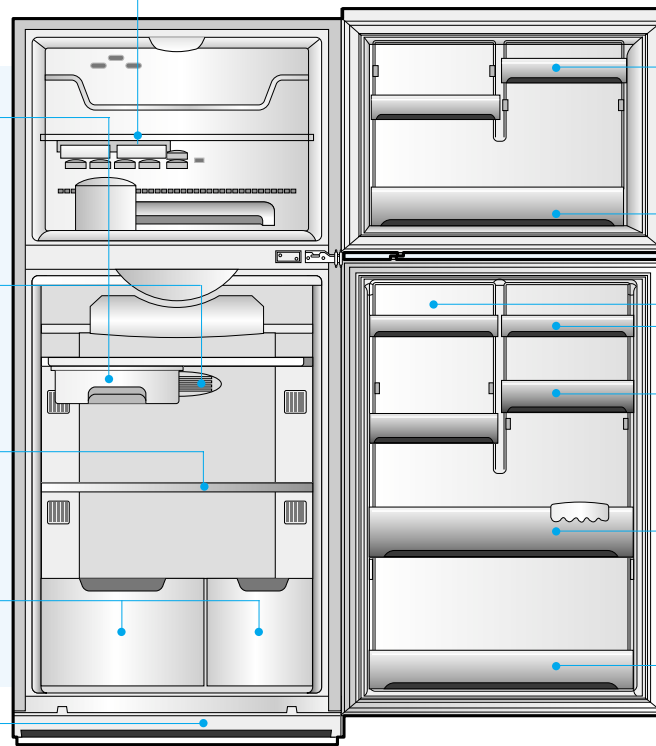

FREEZER COMPARTMENT SHELF

- Provided to make ice or store frozen food.

FREEZER COMPARTMENT POCKETS

- Use when storing...
- Pockets are easy to set according to the size of food container.
- Do not store bottled drinks...

FRESH FOOD COMPARTMENT POCKETS

EGG POCKET

- Use when storing eggs.

FRESH POCKET & COVER

- Use when storing dairy foods such as cheese, butter etc.

MULTI-PURPOSE POCKET

- Use when storing bottled or packed foods, beer cans, spice containers etc.

JUMBO POCKET GUIDER

- It prevents touch and breakage of bottles in the pocket.

JUMBO POCKET

- Use when storing large size bottles, tall food containers etc.

BOTTLE POCKET

- Use when storing small size bottles, food containers etc.

5. TEMPERATURE CONTROL PANEL

TEMPERATURE CONTROL

- Middle mode starts when the refrigerator is first plugged in.
☞ Indicators of LED pieces are lit from "Low" to the middle stage.
- Indicators change from "Low" to "TURBO" by pressing FRZ." or "REF."
- Temperature setting ends just by selecting a mode you want.

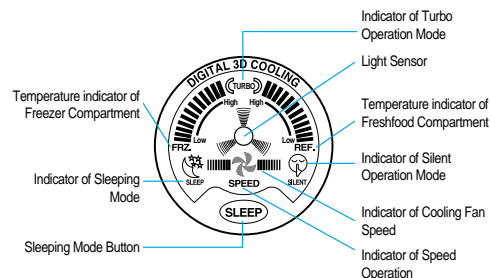

8

SILENT OPERATION

- The Light Sensor catches the amount of surrounding light and it enters the silent operation when sensing that it is night.

☞ Be careful not to hide the Light Sensor.

SPEED OPERATION

- When the sensor feels that the refrigerator needs speedy operation due to heavy load, frequent door openings etc., Speed Operation starts automatically.

SLEEPING MODE

- 1 Just press the "SLEEP" button to start this mode when you want to make the refrigerator stop working before you go to bed.

- 2 This mode continues for maximum 12 hours and returns to the prior mode.

- 3 Just press this button again to stop the mode and it returns to prior mode.

9

6. CARE & CLEANING

Before Cleaning

- When the outside(cabinet, doors) is stained with cooking oil or dirt, wipe it out quickly.
- To keep the inside sanitary without odor or dirt, regular cleaning required at least once a month.
- Spills of cooking oil, butter etc. can cause the parts of plastics to crack.

In Cleaning

- Don't pour water to the refrigerator directly.
- Cleaning the inside, don't use chemical(alkaline) detergent, wax, gasoline, alcohol, benzen, thinner, hot(boiling) water, scrubber etc., cleaning the doors and cabinet, avoid solvent, abrasives, spray-on cleaners etc.
- Instead, use soft cloth with dish washer and clean up with water, dry with a soft cloth.

After Cleaning

- See to the followings after cleaning. If something's wrong, call for service.
- Is the power cord peeled?
- Is the plug hot unusually?
- Did you plug in the outlet firmly?

Front & Rear Rollers

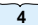
- When cleaning the floor under refrigerator or the behind, shorten the height adjusting feet until the front rollers touch the floor enough and move the refrigerator.
- After cleaning, level the refrigerator by turning the feet. (See  page)

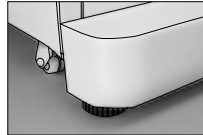

EVAPORATION DISH

New evaporating system, no need to clean at ordinary use.

If it has to be cleaned due to strong odor at midsummer, see the following instruction.

- 1) Unplug the refrigerator.
- 2) Unscrew the cover below back of refrigerator and clean the dish.
- 3) After cleaning the dish, screw the cover and check if anything wrong.

* While cleaning, be careful not to be hurt by hot pipes, compressor etc. and not to break system parts.

7. Helpful Hints

When you replace the light bulbs

Light bulb of freezer compartment

1. Unplug the refrigerator.
2. Pull the light shield down forward, turn to take the bulb out.
3. Replace it with the same size and type of bulb.

Light bulb of fresh food compartment

1. Unplug the refrigerator.
2. Pull out the shelf.
3. Insert your finger into the groove under the light bulb and turn to take it out.
4. Replace it with the same size and type of bulb.

* Call the service center when you get the bulbs or too hard for you to replace it.

In case of power failure

- Do not open and shut the doors, if possible, then no problem storing the food 2~3 hours long even in the midsummer.
- In case of predicted power failure, do not store any more food and make as much ice as you can to put it on the upper shelf of fresh food compartment. The inside would be kept cold.



When not using for a long time

- Clean the inside and leave the doors open for 2~3 days in order to prevent mold development or odor saturation.



8. Efficient Storage of Foods

- Be sure to wrap foods - fish, meat, etc. - to be stored in the freezer compartment to avoid odor.

Keep foods clean !

- Be suWipe the packed foods, wash vegetables.



Cool down to room temperature !

- If hot food is put in immediately, the temperature inside rises up, keeping foods fresh impossible, resulting in waste of electricity.



Divide foods into one-time serving !

- Dividing food into one-time serving and storage makes it easy to take out, enhancing refrigerating power. Frozed food can be thawed easily.



Wrap foods !

- Make sure to wrap foods such as Kimchi and fish in order to prevent drying and odor.



Do not fill the inside up !

- Too much food will interfere with cold air circulation. Do not place watery food close to the cold air ducts.

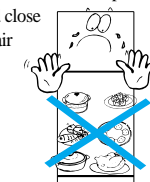

Open and shut doors quickly !

- Frequent opening and shutting doors causes loss of cold air, waste of electricity weakening of refrigerating power.

